

FAG

6018-H-SN

Deep groove ball bearing

Schaeffler ID:
0949147020000Deep groove ball bearing 60..-H, single
row, H-Series, steel sheet metal cage

Technical information

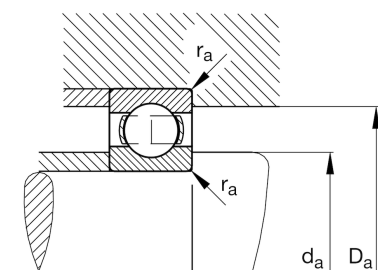
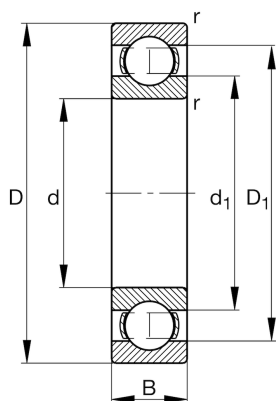
**Main Dimensions & Performance Data**

| | | |
|----------|-------------|-----------------------------------|
| d | 90 mm | Bore diameter |
| D | 140 mm | Outside diameter |
| B | 24 mm | Width |
| C_r | 52.340 N | Basic dynamic load rating, radial |
| C_{0r} | 45.080 N | Basic static load rating, radial |
| C_{ur} | 2.600 N | Fatigue load limit, radial |
| n_G | 5.600 1/min | Limiting speed |
| n_{gr} | 5.600 1/min | Reference speed |
| | 1,18 kg | Weight |

Dimensions

| | | |
|-----------|----------|------------------------------|
| r_{min} | 1,5 mm | Minimum chamfer dimension |
| D_1 | 124,2 mm | Shoulder diameter outer ring |
| d_1 | 105,8 mm | Shoulder diameter inner ring |

Mounting dimensions

| | | |
|-------------|--------|--------------------------------------|
| $d_{a min}$ | 97 mm | Minimum diameter shaft shoulder |
| $D_{a max}$ | 133 mm | Maximum diameter of housing shoulder |
| $r_{a max}$ | 1,5 mm | Maximum fillet radius |

Calculation factors

| | | |
|-------|------|--------------------|
| f_0 | 15,8 | Calculation factor |
|-------|------|--------------------|

Temperature range

| | | |
|-----------|--------|----------------------------|
| T_{min} | -30 °C | Operating temperature min. |
| T_{max} | 120 °C | Operating temperature max. |